



13 THRALE ROAD, STREATHAM,
LONDON, SW16 1NS

£30,000 Per Annum



CHRISTOPHER ST. JAMES
Established 1976

Residential / Commercial / Land & Development

020 8296 1273

www.csj.eu.com

info@csj.eu.com

Full Description

Ground floor E class unit with basement, private garage and garden area to the rear.

The property is currently sub - divided into 5 rooms and is offered stripped out ready for the new tenant / owners to begin their fit out

Location

The property is situated within a mixed use parade

The location is serviced by a number of bus routes from stops in the area; Streatham and Streatham Common Mainline stations are located within 10 mins walk, providing frequent links into Central London

Terms

Guide Rent £30,000 pa

Guide Price £300,000 Freehold

Viewing

By appointment only

Contact sole agents

Daniella Davies

CSJ Property

020 8296 1273

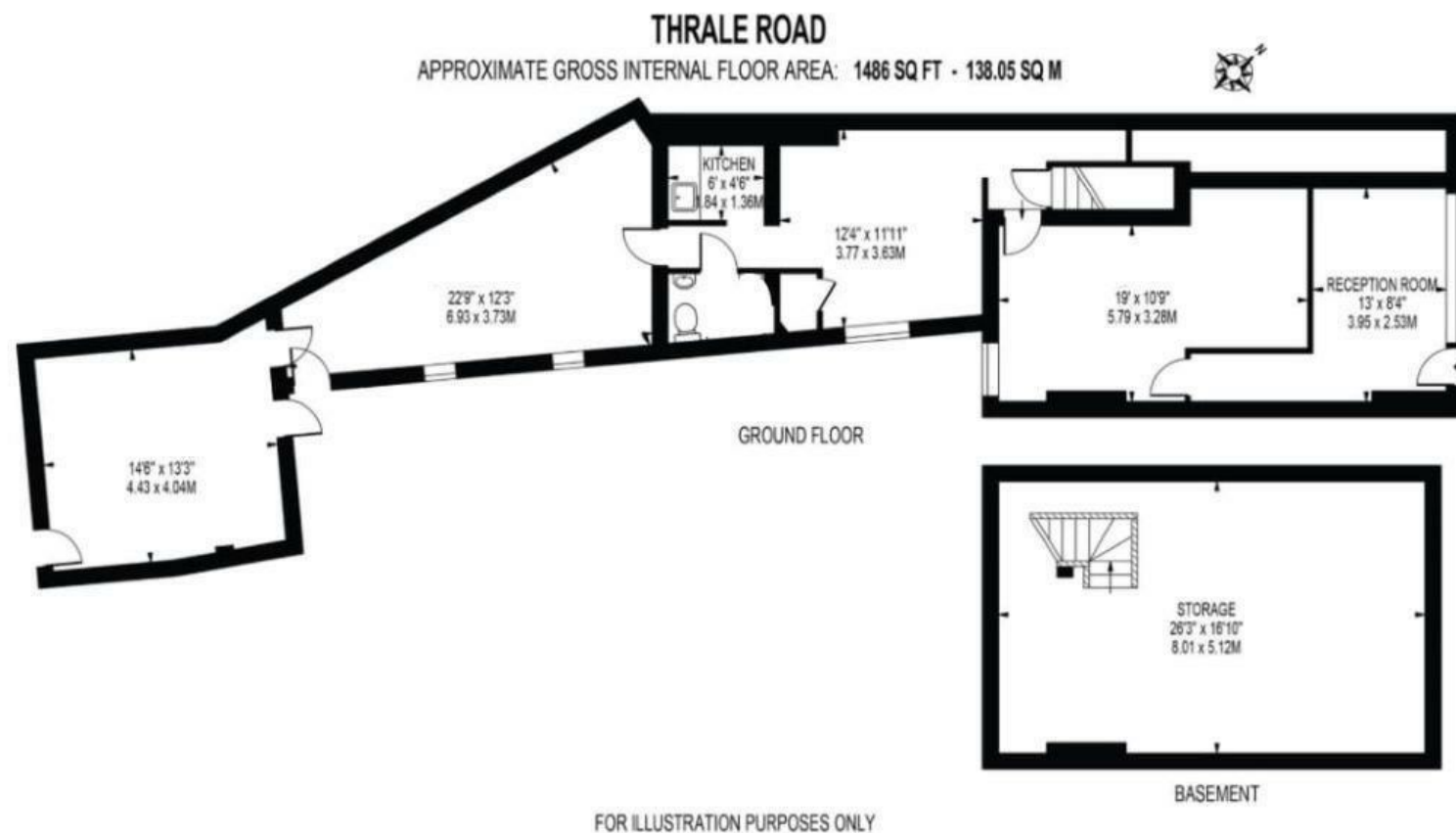

THE SMALL PRINT

Christopher St James, our clients and any joint agents give notice that:

1) They have no authority to make or give any representations or warranties in relation to the property. These particulars do not form part of any offer or contract and must not be relied upon as statements or representations of fact.

2) Any areas, measurements or distances are approximate. The text, photographs and plans are for guidance only and not necessarily comprehensive. It should not be assumed that the property has all necessary planning, building, regulation or other consents and Christopher St James have not tested any services, equipment or facilities. Purchasers must satisfy themselves by inspection or otherwise.

Christopher St James

61 High Street

Colliers Wood

London

SW19 2JF



CHRISTOPHER ST. JAMES
Established 1976

Residential / Commercial / Land & Development

020 8296 1273

www.csj.eu.com

info@csj.eu.com