



199 - 201 WANDSWORTH HIGH STREET,
WANDSWORTH, LONDON, SW18 4JE

£500,000 Leasehold



CHRISTOPHER ST. JAMES
Established 1976

Residential / Commercial / Land & Development

020 8296 1273

www.csj.eu.com

info@csj.eu.com

Wandsworth High Street, SW18 4JE

Approx. Gross Internal Area 892 Sq Ft - 82.87 Sq M

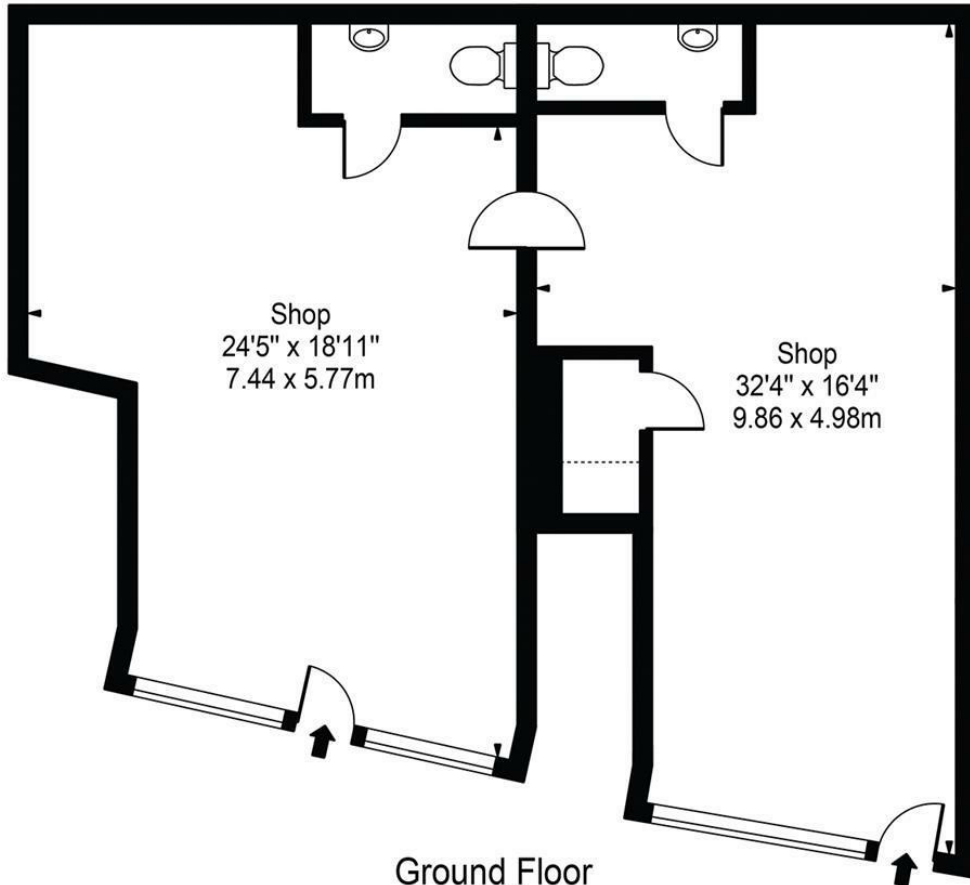

For Illustration Purposes Only - Not To Scale - Floor Plan by interDesign Photography
www.interdesignphotography.com

This floor plan should be used as general outline for guidance only.
All measurements are approximate and for illustration purposes only as defined by the RICS Code of Measuring Practice ©2016.

Location

Situated within a mixed use parade on the A3 Wandsworth High Street with heavy traffic flow and footfall.

Wandsworth is located in South West London and benefits from excellent transport links into the city, Nearby Old York Road offers boutiques, cafes, galleries and restaurants, along with Southside shopping centre with its various shops, supermarket and entertainment. Wandsworth Park and riverside are a short stroll away.

Nearest Stations:

Wandsworth Town (South Western Railway Services) 0.6 miles

East Putney Underground Station (District Line) 0.6 miles

Description

Ideal for investors or owner occupiers

Double fronted former retail space suitable for a variety of uses subject to the relevant consents, the property is available as a whole or separately and each unit is fitted with its own private W/C with wash basin

Key information

Leasehold: 999 yrs

Service charge: Approx £800 pa to include insurance, maintenance and management

Services: Electric & Water only (Not checked by CSJ)

Terms

The property is for sale with a virtual freehold (999 yr lease) as a whole or split

Whole: £500,000 + VAT

Individual: £275,000 + VAT

Viewings

Contact sole agents Christopher St James 020 8545 0591

THE SMALL PRINT

Christopher St James, our clients and any joint agents give notice that:

- 1) They have no authority to make or give any representations or warranties in relation to the property. These particulars do not form part of any offer or contract and must not be relied upon as statements or representations of fact.
- 2) Any areas, measurements or distances are approximate. The text, photographs and plans are for guidance only and not necessarily comprehensive. It should not be assumed that the property has all necessary planning, building, regulation or other consents and Christopher St James have not tested any services, equipment or facilities. Purchasers must satisfy themselves by inspection or otherwise.

Christopher St James
61 High Street
Colliers Wood
London
SW19 2JF



CHRISTOPHER ST. JAMES
Established 1976

Residential / Commercial / Land & Development

020 8296 1273
www.csj.eu.com
info@csj.eu.com