

- Terms & Conditions**
- All dimensions must be checked on site prior to the start of any building works and manufacture of fittings, ordering of materials.
 - All goods and equipment must be approved by client and project manager before purchasing and commencing on site.
 - Do not scale from this drawing.
 - Any conflicting information found on the drawing must be clarified with Design Doctor.
 - All materials and workmanship to be in accordance with relevant and current British Standards and codes of practice.
 - This drawing remains the copyright of Design Doctor until otherwise agreed (or full payment has been received and contract completed)
 - Drawings cannot be reproduced in any form without prior written consent from Design Doctor.
 - Drawings also cannot be issued to sub-contractors without prior written consent from Design Doctor.
 - These drawings have been primarily created for planning approval.
 - These drawings are also designed to assist in project scheduling, material & labour budget analysis purposes.
 - Drawings must only be read in conjunction with the other associated drawings which make up a complete set for a specific project.
 - All details shown must only be regarded as a guideline (as no structural engineer has been appointed or Building Control engaged).
 - They therefore must not be used for construction.
 - All building works must be carried out in accordance with current Building Control regulations and British Standards.
 - All works cannot be started until full local authority Planning Permission has been granted and a Start Certificate has been issued by independent Building Control.
 - The designs shown are only a guideline and should be read in conjunction with a full package of detail drawings marked 'Approved' [and] have been sent to Building Control and registered in the appropriate manner.
 - It should also be noted demolition or works should not be carried out before a full asbestos survey has been carried out by the appropriate authorities
 - Please Note: If any one of the above terms are deliberately contravened, Design Doctor cannot be held responsible for any second and third party actions (and may be forced to withdraw any pre-agreed consent, terminating any open contracts).

Rev No.	Details of Revision	Date:

Andy Marley	
324 Kingston Road Ewell Surrey KT3 T33	
Existing ground floor layout	
Rev:	
Date:	16-11-2020
Drawn By:	LK
Approved By:	
Drawing No.	002
Scale:	1:50 @ A3

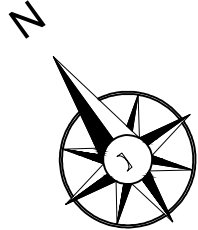
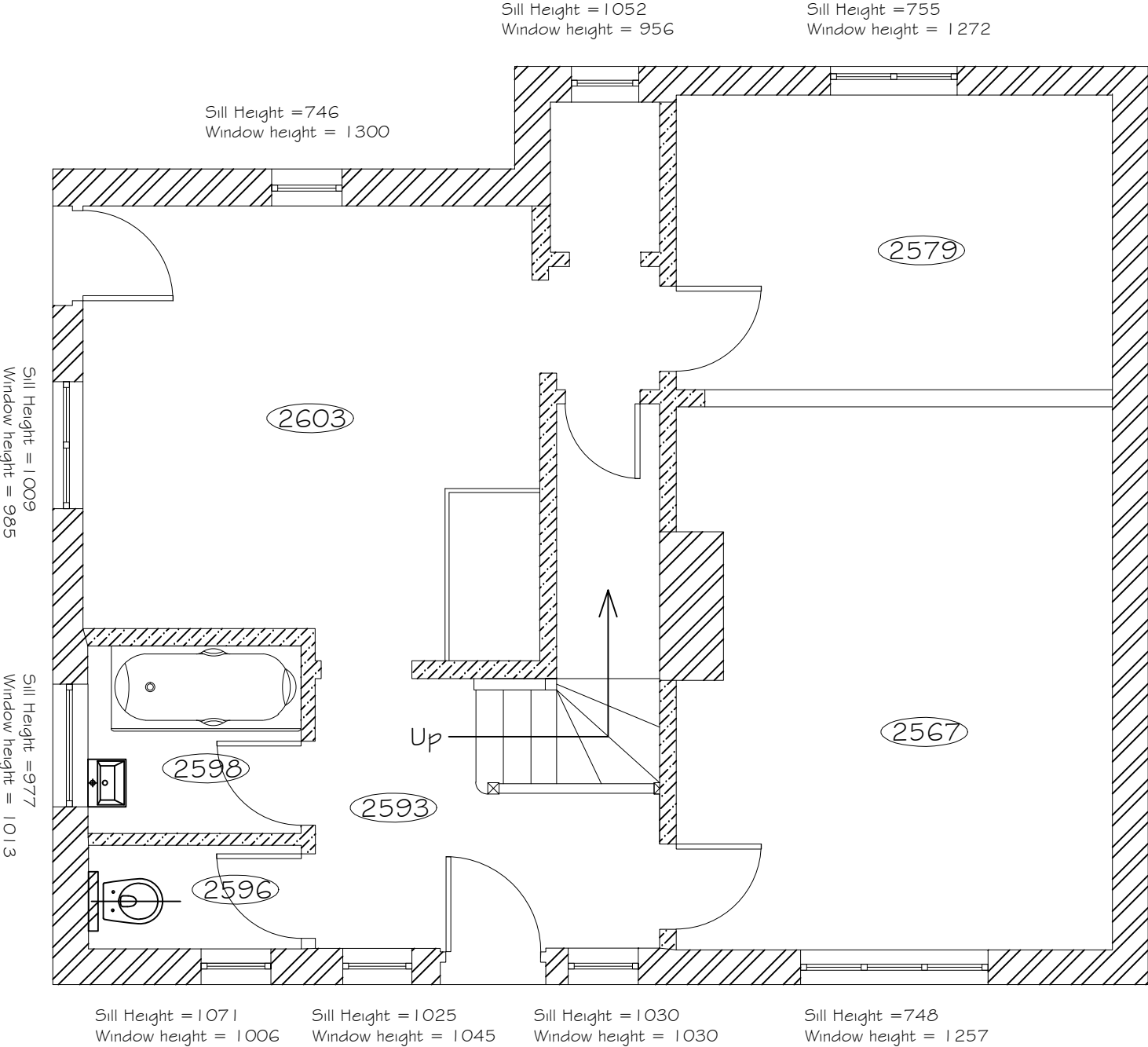

Approval
16/11/2020

