



TO LET



First Floor, 1b Walton Way, Mitcham, London, CR4 1HQ

£1,450 PCM



C

S

J

- Brand New Home
- One Bedroom
- Parking
- 0.7 miles to Eastfields Station
- Ground Floor
- Garden
- Close to Town Centre
- Available to View

## THE PROPERTY

Brand new one bedroom garden flat located close to Town Centre, British Rail Station and Mitcham Common

Walton Way,  
Mitcham, Surrey, CR4 1HQ  
Approx. Gross Internal Area 425 Sq Ft - 39.48 Sq M

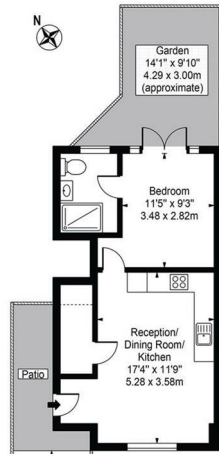

Ground Floor

For Illustration Purposes Only - Not To Scale - Floor Plan by InterDesign Photography  
www.interdesignphotography.com  
This floor plan should be used as general outline for guidance only.  
All measurements are approximate and for illustration purposes only as defined by the RICS Code of Measuring Practice 02/16.

## SITUATION

## Directions